

AIRDRIVE KEYBOARD ASSISTANT WI-FI QUICK START



Important tips:

- Works only with external USB keyboards, does not work with laptop keyboards
- To configure, connect to Wi-Fi network AIR_XXYYZZ and open 192.168.4.1
- The Wi-Fi connection is only necessary for configuration and to access stored data



Always connect the device
in-line between the
keyboard and
computer

Connect to Wi-Fi network

AIR_XXYYZZ

where XXYYZZ is a distinctive device ID

Use any web
browser to
open address
192.168.4.1
and configure
shortcuts

Information:
the device is actually a
WiFi Access Point to
which you can connect
using a laptop, tablet,
smartphone, or desktop

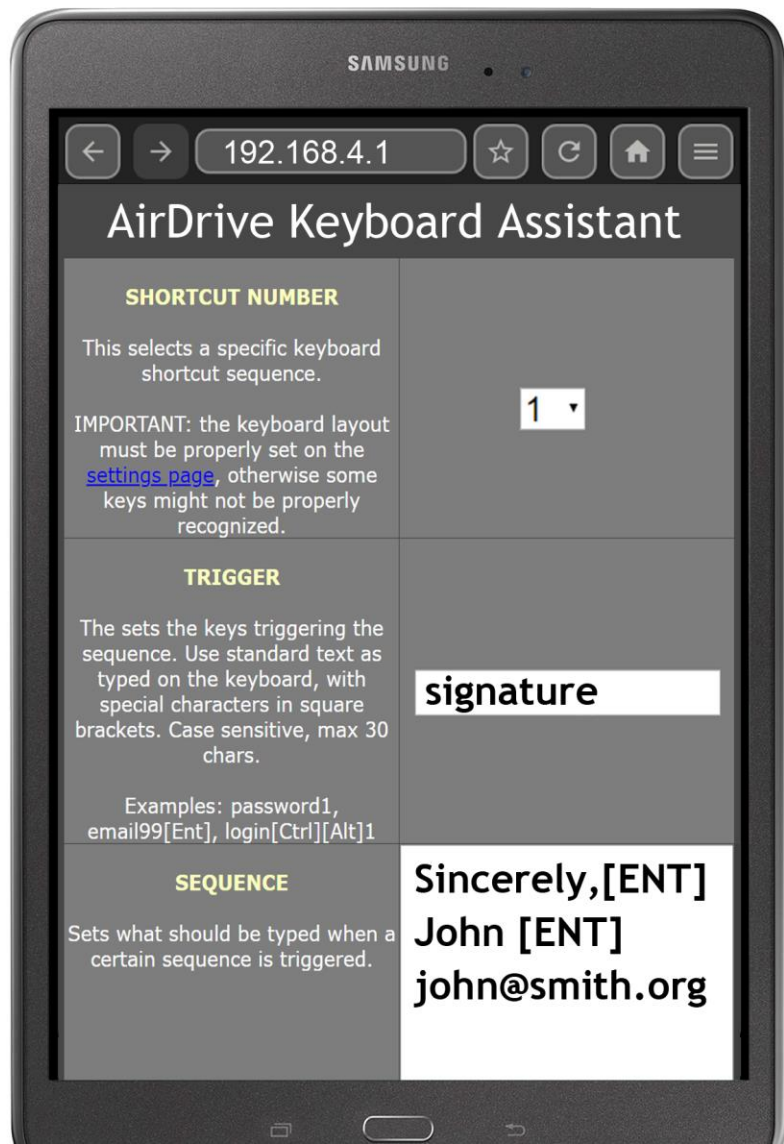

Definition of a shortcut sequence

TRIGGER -> SEQUENCE

Type the trigger to launch the sequence

Long word example:

pachy -> Pachycephalosaur

You type: *pachy*

The device will type *Pachycephalosaur*

Website login example:

web[ALT]1 -> MyUser[TAB][2]MyPass[ENT]

You type: *web* and press **ALT+1**

The device will type *MyUser*, then it will press **TAB**, wait 2 seconds, type *MyPass* and **ENTER**

Text with formatting example:

flowers -> Don't forget to [CTL]B water the flowers! [CTL]B [ENT] Thanks, Ted

You type: *flowers*

The device will type the reminder text, emphasizing *water the flowers!* with **CTRL+B** (works in most word processors)

Shortcut settings are available on the main page, while Wi-Fi and keystroke recognition are on the settings page

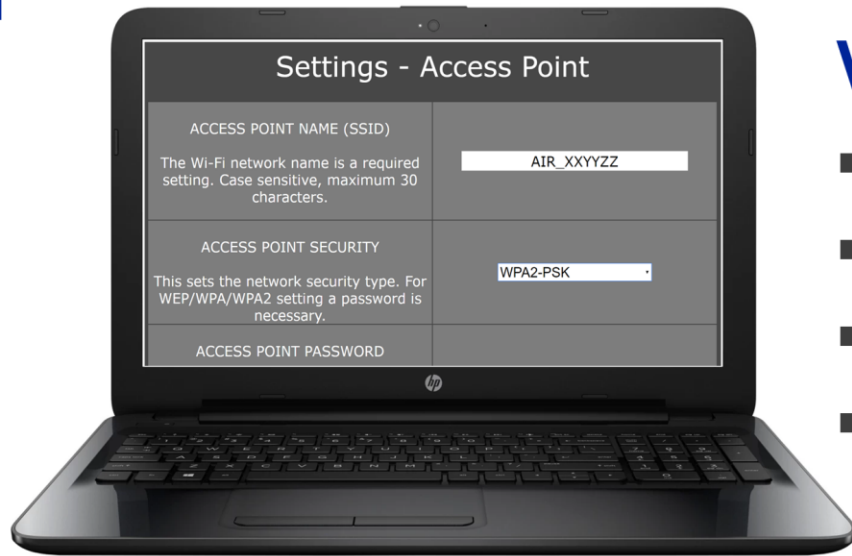

Wi-Fi settings:

- SSID
- Authentication
- Password
- Hidden SSID

Shortcut settings:

- Keystroke speed
- Trigger blanking
- Trigger delay
- Enable/disable

Scripting:

- Triggers
- Payloads
- Keystroke speed
- Delays

For language-adapted keyboards, make sure to select the proper keyboard layout

The device can also run keystroke scripts, containing commands, loops and delays. Refer to keystroke scripting guide.